

PLAN VIEW

Inlet Top Unit and Grate as required

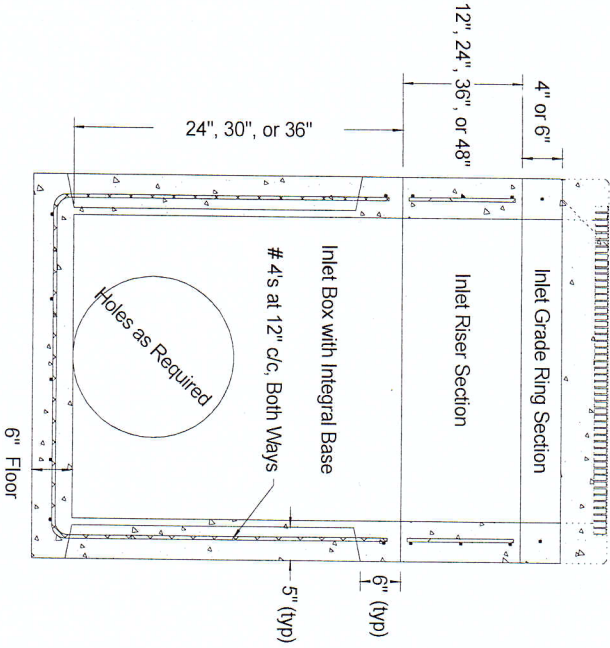

ELEVATION VIEW

SECTION A-A

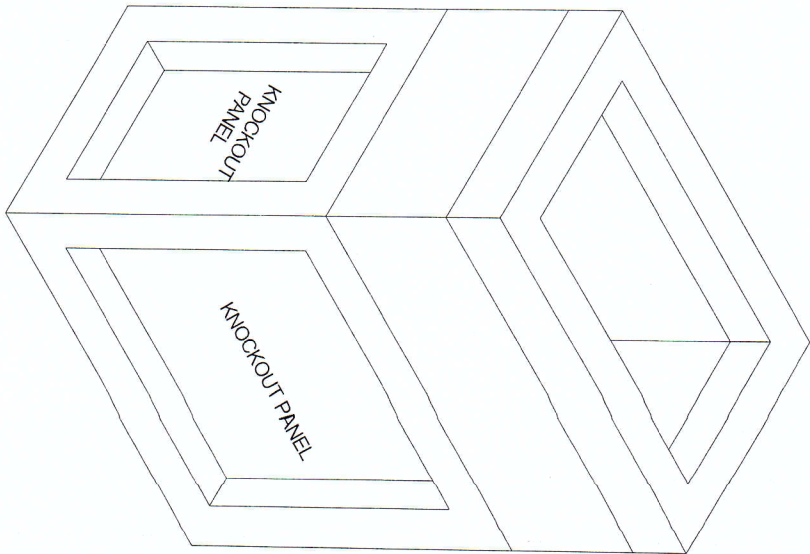

NOTES:

1. Cement Concrete - 4,000 psi in 28 days.
2. Reinforcing - 60 Ksi, plain, meeting ASTM A615.
3. Minimum 1 1/2 inches clearance to reinforcing.
4. Openings in riser sections on request.